



**SHOOTERS**  
ARMS MANUFACTURING INCORPORATED

**1911 Pistols**

## OPERATION & SAFETY MANUAL



We specifically disclaim any responsibility for damage or injury whatsoever incurred as a result of the use of faulty, sub-standard or remanufactured ammunition, any modifications or changes made to the firearm and improper use or unsafe handling of the weapon. **FIREARMS SAFETY IS THE SOLE RESPONSIBILITY OF THE SHOOTER. ALWAYS TREAT ALL FIREARMS AS IF THEY WERE LOADED.**

**IMPORTANT!** READ ALL INSTRUCTIONS AND WARNINGS IN THIS BOOKLET BEFORE USING THIS FIREARM.



**Be a responsible gun owner. Use it safely, store it securely, and always transfer ownership of a gun responsibly and legally.**

# CONTENTS

Page	Title
1	BEFORE LOADING AND FIRING THIS PISTOL, READ AND UNDERSTAND THE INFORMATION IN THIS MANUAL
2	KNOW YOUR GUN
3	SAFETY RULES / BE A RESPONSIBLE GUN OWNER / BE A SAFE SHOOTER
4	READ THE RULES / PORTED BARREL SAFETY INSTRUCTIONS
5	BARREL SAFETY INSTRUCTIONS
6	BE A SAFE SHOOTER / HANDLING
7	LOADING / FIRING
8	UNLOADING
9	HAMMER LOWERING / MALFUNCTION WARNING / ELIMINATE MALFUNCTIONS
10	DISASSEMBLY FOR STANDARD BARRELED MODELS
11	DISASSEMBLY FOR FOR TITAN & SIGMA 9 MODELS
12	ASSEMBLY / CAUTION / TREAT GUN AS IF IT IS LOADED... ALL THE TIME!
13	EXPLODED VIEW
14	CARE AND CLEANING / CLEANING PISTOL
15	PERIODIC CLEANING: EXTRACTOR / LIMITED LIABILITY

# BEFORE LOADING AND FIRING THIS PISTOL, READ AND UNDERSTAND THE INFORMATION IN THIS MANUAL

This is an auto loading pistol. It is immediately loaded and ready to fire again after each shot until all shells loaded in magazine have been fired. However the pistol is able to fire with or without the magazine in place as in the case of a bullet remaining in the chamber. Removing the magazine does not unload the pistol nor engage the safety. The pistol is not unloaded until the chamber is empty.

## ***Owners manual***

This is an instructional booklet on how to operate this firearm with basic safe handling rules. It does not attempt to provide information about using a gun to defend yourself, how to hunt, or for competitive or target shooting. It is important to get instruction from a competent instructor prior to engaging in any of these activities. The local or state authorities, or your gun dealer may provide information regarding available instructors or training courses. If you have a license to carry a firearm, never do so without prior training from a certified instructor. Using a gun for self defense is a complex subject with dangers and risks for which you must be properly trained. Every safety rule has a purpose - read the rules carefully and understand why fully.

## ***Store guns safely***

Unload the firearm properly before storing it, locked and in a secure place. Obey gun storage laws. Store guns and ammunition separately. Educate minors in the home on gun safety but never in handling of the weapon.



# KNOW YOUR GUN

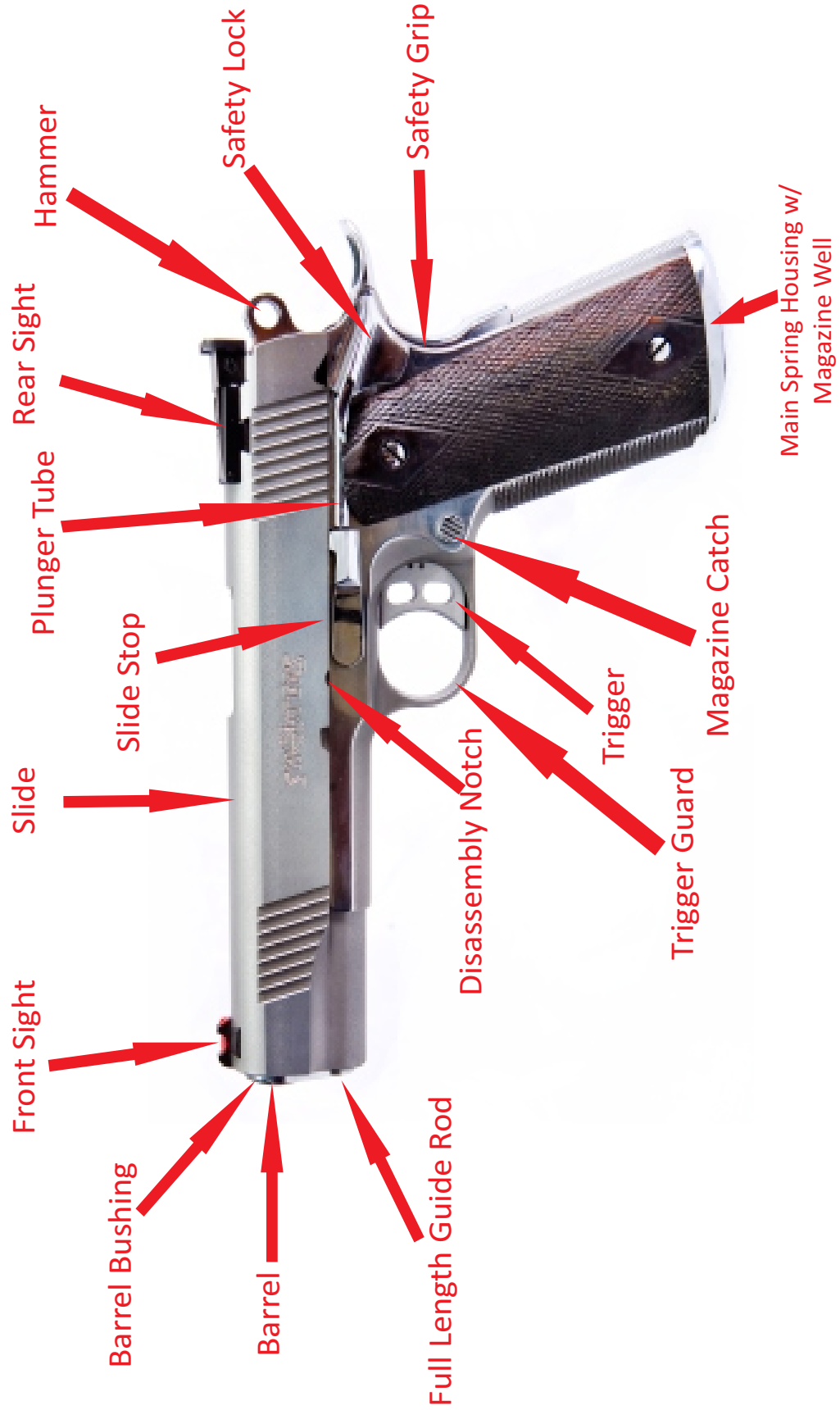

# SAFETY RULES

## READ AND UNDERSTAND THESE SAFETY RULES

### *Be A Responsible Gun Owner.*

A responsible gun owner always keeps safety in mind and follows the basic rules of safe shooting and by using common sense in the handling of a firearm.

Store unloaded firearms in a locked and in a secure place. Keep keys for locks separate from lock and in a secure place away from children. Keep firearms out of reach of children. As a gun owner you are responsible for the children's safety.

### *Be A Safe Shooter*

Always keep the muzzle pointed in a safe direction. Never point a gun at a person or a thing you do not intend to shoot. Do not drop your gun as it may fire even with the safety on.

If you do drop it, unload it and examine it to be sure it works properly. Do not attempt to fire it again until you have completed this safety check. Never put your hands over the muzzle of the gun. Keep your fingers off the trigger and out of the trigger guard until you are actually aiming at your target and ready to shoot.

## TREAT EVERY GUN AS IF IT IS LOADED...ALL THE TIME

## BE A RESPONSIBLE GUN OWNER!

- ✿ Never rely on a gun's "safety mechanism" to protect you from accidents. The mechanism is only a mechanical device, not a substitute for common sense and gun safety training.
- ✿ If anything does get into the barrel, remove cartridges, and clean bore immediately before attempting to shoot. Obstructed barrels can burst and injure you or bystanders.
- ✿ When the gun is loaded and cocked, always keep the thumb safety on until you are ready to fire.
- ✿ Never let water, snow, mud or other materials enter the barrel.
- ✿ Be sure of your target. Be aware of your surroundings in case you miss your target.
- ✿ Never pull a gun toward you by the muzzle.
- ✿ Before shooting, be sure the barrel is clear of obstructions including excessive oil and grease.
- ✿ Do not perform rigorous physical activities with a loaded gun.
- ✿ Always keep a tight grip on your gun so you control the direction of its muzzle in case you fall or stumble.

## BE A SAFE SHOOTER!

- ✿ Guns and alcohol or drugs do not mix. Do not take them before or during shooting activities. Your vision, coordination and judgement could be impaired, making gun handling unsafe.
- ✿ Always keep and carry your pistol with an empty chamber and with the hammer forward until you intend to shoot, so your pistol cannot be fired unintentionally.
- ✿ When taking medication, seek a doctor's advice to make certain you can operate and handle your firearm safely.
- ✿ Firearms should be unloaded when not in use. This means both the chamber and the magazine must be emptied out.
- ✿ Get instructions from a competent firearms instructor before using any firearm.
- ✿ When handing over the gun, always ask the person receiving it to open the action and check that it is unloaded.
- ✿ Before attempting to shoot, practice operations by dry firing with an empty chamber, without ammunition, or with dummy shells. Become familiar with the safety features, trigger control, and handling.
- ✿ Never take anyone's word that a firearm is unloaded. When receiving a gun, always open the action and check if it is unloaded.

# READ THESE RULES!

- ☀ Always load shells from the magazine and keep your finger off the trigger.
- ☀ Load the gun only when inside the firing range preparing to fire. Unload it before leaving the firing range.
- ☀ Treat every gun as if it is loaded...**all the time!**
- ☀ Load and unload the gun pointed in a safe direction.
- ☀ Be certain the gun is completely unloaded before cleaning.
- ☀ Completely unload your gun before cleaning, storing, travelling, or handing it over to another person.
- ☀ Never leave a loaded gun unattended.
- ☀ To avoid accidents, keep gun secured and away from children's reach.
- ☀ Store guns and ammunition separately.
- ☀ Obey all laws regarding the storage and security of guns in the home.
- ☀ Know and obey the laws regarding the transportation and carrying of firearms.
- ☀ Never carry any handgun in your pocket, purse or tucked in your belt or waistband. Use a pistol case or a proper holster with safety flap or strap.
- ☀ New non-defective brass is essential to ensure safe functioning of your gun.
- ☀ Old or reloaded ammunition may be dangerous. Use only clean, dry original, high quality, commercially manufactured ammunition.

## PORTED BARREL SAFETY INSTRUCTIONS

### Warnings, Ammunition Restrictions, and Maintenance

Completely read this safety manual before using a ported barrel pistol. Transfer this manual to any subsequent owner or user of the pistol. If you are inexperienced in the handling of firearms, obtain expert instruction before attempting to shoot. Neither this manual nor this product can take the place of proper instruction in the safety aspects of shooting, the use of firearms, and the use of firearms for self-defense. Severe injury to hands, eyes, face, other persons or property will occur with improper use of a ported barrel pistol.

### Safety Notes

Always use an eye or ear protection when shooting or when in close proximity to shooting. A ported barrel pistol, common in most pistols using muzzle brake devices, produces greater noise than normal pistols and this poses a danger to hearing. Never position any part of the body over the exhaust ports. Never cycle the slide with your hands over the exhaust ports. Never point a gun on anything you do not intend to shoot. If the ported pistol is drawn rapidly it must not be discharged in proximity to the shooter or bystanders. Do not shoot a ported barrel from the hip. The blast from the exhaust ports can cause injury or property damage several feet away. Use caution when shooting to avoid overhead objects that may be damaged by the blast from the barrel exhaust ports.



Always point gun in a safe direction.  
Keep your gun unloaded until you are ready to shoot.

# BARREL SAFETY INSTRUCTIONS

## **Ammunition**

Use only newly produced factory quality ammunition. DO NOT use handloads, reloads, remanufactured ammunition in your firearm. Only shoot cartridges of the caliber engraved on the barrel. Do not use shot cartridges or any ammunition which is loaded with any ultra-light weight (wooden or plastic) projectile at elevated velocities.

## **Caution**

Fragments of the metal jackets on jacketed bullets may be propelled through the exhaust ports with great force. The misuse of any of the ammunition described above may result in injury, property damage, or death even from a distance of several feet.

## **Maintenance**

Accumulated debris in the barrel exhaust ports may result in damage to the pistol or injury to the shooter. With the gun unloaded, regularly inspect the bore and exhaust ports for dirt and debris. Never discharge the firearm when any form of debris is present in the barrel or exhaust ports.

# BE A SAFE SHOOTER!

- ☀ Do not try to change your gun's trigger pull, as this usually affects the sear engagement and might cause accidental firing.
- ☀ Never disassemble the safety as this has been correctly designed, fitted and tested. Any mechanical device can fail, however, so never rely on the safety mechanism as substitute for safe handling.
- ☀ Never use a gun that jams or fails to function properly. Should this occur, return it to the gun dealer/store where you purchase your gun for warranty/repair.
- ☀ If the shot sounds weak or underpowered, it could mean a bullet is in the chamber/bore. The gun should be immediately unloaded and the chamber/bore checked for obstruction before refiring.
- ☀ Do not "horseplay" with a gun. Firearm safety depends on you and is the responsibility of the operator.

Write to us concerning any items you do not understand and/or which might relate to your safety and the safe operation of any of our products. Our email address is at

[askshooters@gmail.com](mailto:askshooters@gmail.com) or fax us thru this number **(+6332) 344-8515**.

## CAUTION!

*There is no safe way to discharge a pistol in home or apartment. Bullets will go through walls, floors, furniture, and appliances and still cause serious injury or death to persons within the vicinity.*



When you squeeze the trigger, you must expect the gun to fire. Your gun and the safety of others around you is your sole responsibility.

## HANDLING

### We want you to be safe, educated shooter.

Before attempting to load this firearm with live ammunition, follow the sequence of operations shown here without ammunition or with dummy shells.

By practicing operations without ammunition (or with dummy shells), you will become familiar with:

- ☀ Safety features,
- ☀ Trigger control (dry firing)
- ☀ and handling of your firearm.

As a result you will be a safer, more confident shooter.

### Safety Stop on Hammer

The Safety Stop is a flat, shelf-like surface on the hammer which functions automatically. It will engage the sear in the unlikely event of primary sear notch failure. This will prevent the hammer from falling fully forward unintentionally and will prevent uncontrolled automatic fire, it also prevents the hammer from striking the firing pin should your hand slip from the slide or hammer while cocking the pistol, provided the hammer is rotated past the Safety Stop. It is located such that when the sear engages the Safety Stop, the sear can be disengaged by squeezing the trigger. It falls because the sear slides over the flat part of the safety stop to release the hammer. This is intentional but will not allow the pistol to fire. It will not fire because the hammer is almost fully forward when it is released from the sear. The Safety Stop is not a manual safety and should not be engaged by hand. Do not carry the gun while Safety Stop is engaged.

**Caution:** Control hammer with your thumb and always point pistol in safe direction when squeezing the trigger to lower the hammer. This will avoid accidental injury in the unlikely event of pistol discharge. Lowering the hammer in this way should be done only when the chamber is empty.



# LOADING

1. Place the empty magazine in the magazine well, located in bottom of pistol grip. Push firmly enough on bottom of magazine to make sure it is properly seated. A distinctive “click” will confirm the magazine has been properly inserted. Pull the slide all the way to the rear, until it locks back.
2. Depress magazine release and remove magazine. Place rim of first cartridge on the front of follower. Then push down on the follower and slide cartridge under the lips of the magazine and to the rear. Load successive rounds the same way. Use only clean, dry, original, high-quality, commercially manufactured ammunition.
3. Re-insert magazine into magazine well, located in bottom of pistol grip. Push firmly enough on bottom of magazine to make sure it is properly seated.
4. Point gun in safe direction and keep finger off trigger. Pull slide back and release slide smartly to allow slide to move forward and load a shell from the magazine into the chamber.

**WARNING!** Always load shells from the magazine to prevent damage to trigger and sear.



Never touch the trigger when loading or unloading the pistol

# FIRING

Point a gun in a safe direction at all times.

If you have never fired a gun before, practice without live ammunition before your first shot. Then load only one cartridge into the magazine for your first live ammunition firing.

1. Load shell into chamber from magazine and engage the thumb safety.
2. Grasp grip of pistol firmly. (A loose grip may cause the pistol to malfunction) The pressure from the hand will disengage grip safety located at the top of rear grip area.
3. Move thumb safety down taking gun off safety. **Caution:** The gun is now ready to fire. Be prepared for noise and recoil when pistol fires.
4. Aim gun at target by aligning sights.
5. Lightly place finger on trigger, and slowly squeeze trigger. Spent cartridge is expelled up and to the right.

6. Pistol will automatically be ready to fire again after each shot until all cartridges loaded in magazine have been fired.
7. When last cartridge has been fired, slide will lock open and remain to rear.

**WARNING!** When releasing the slide on an empty chamber or when loading a single round without the magazine do not allow the slide to slam forward. Doing so will destroy the hammer and sear engagement on your trigger pull and put you at risk of accidental firing. It could also cause damage to the other finely tuned parts of your pistol.

**TO PREVENT DAMAGE AND FOR SAFETY REASONS** Always load shells from the magazine. If you want to carry your gun with a shell in the chamber and a full magazine, follow this procedure: Load a shell into the chamber from the magazine. Then remove the magazine, fully load it and insert it properly into the gun.

# UNLOADING

If slide is already in “locked back” position:

1. Point gun in a safe direction.
2. Press magazine release button to remove magazine.
3. From top and rear, carefully inspect chamber to make sure it is empty.
4. Hold slide, disengage slide stop, ease slide forward.  
*Notice:* The slide of a 1911 pistol should never be released on an empty chamber; especially one which has had an action job. Releasing the slide on an empty chamber causes damage to the breech face on the barrel and undue stress on all action parts, including the hammer and the sear. This will ruin the action job performed on your pistol.
5. Carefully lower hammer as described in the **HAMMER LOWERING** section at *page 14*.

If slide is in forward position and the hammer is cocked:

1. Point gun in a safe direction.
2. Engage thumb safety.
3. Press magazine release button to remove magazine.
4. Disengage thumb safety.
5. Pull slide fully to rear to eject any cartridge remaining in chamber.
6. While holding slide in rearward position, carefully inspect chamber making sure it is empty.
7. Slowly release slide, allowing it to return to forward position.
8. Carefully lower hammer as described in **HAMMER LOWERING** section *page 14*.



Pistol is not empty or unloaded until the chamber is empty and the magazine removed. Never touch trigger when loading or unloading the pistol.

# HAMMER LOWERING

1. Point gun in a safe direction and ensure pistol is unloaded.
2. Firmly hold gun, depressing grip safety.
3. Using non-shooting hand, firmly grasp hammer with thumb.
4. Be prepared for hammer movement. Squeeze trigger.
5. Slowly lower hammer with thumb and forefinger until it is fully in forward position.
6. Release trigger. (If the trigger is released early the gun may be on the Safety Stop.)



*Note: Always keep and carry your pistol with an empty chamber and with the hammer forward (down) until you intend to shoot, so your pistol cannot be fired unintentionally.*



**Caution:** If pistol is loaded, gun may discharge if the hammer slips from your grip during this procedure.

## MALFUNCTION WARNING!

1. What to do:
  - ☀ Point gun in a safe direction.
  - ☀ Remove magazine.
  - ☀ Pull back on slide and allow cartridge to fall from gun.
  - ☀ If cartridge does not fall free, pull slide back and lock it back.
  - ☀ Carefully dislodge cartridge.
  - ☀ If cartridge cannot be removed, carefully store your gun and take it to a gunsmith.
2. Most failures of cartridge to feed or chamber are the result of damaged magazine, improper gun handling or defective ammunition.
3. Whatever the cause, a jammed cartridge poses a serious risk. Should the shell be discharged while out of chamber, cartridge will rupture and fragments will be blown out of pistol with sufficient force to cause injury.



**Always have gun pointed in a safe direction. Failure to obey safety information may result in injury to you or others.**

## TO ELIMINATE MALFUNCTIONS

1. Change type/brand of ammunition and/or magazine.
2. If changing to another type/brand of ammunition and/or magazine does not at once result in smooth feeding of cartridges from magazine to chamber, the following steps should be taken:
  - ☀ Make certain chamber and magazine are unloaded. Magazine should be removed first. Check chamber and magazine to ensure both are clear of cartridges.
  - ☀ Thoroughly clean magazine, paying particular attention to removing accumulated grease. Thoroughly clean breech mechanism of pistol. Use a bristle brush and solvent to remove grease and fouling from breech space, extractor, chamber and feed ramp.
  - ☀ Check that magazine spring tension is adequate. The spring should hold the follower tightly against the lips of the magazine.
  - ☀ Check that magazine lips are free of nicks and burrs and are not deformed.
  - ☀ Remove excess oil and solvent from all cleaned components, load magazine and try firing the pistol again.

# DISASSEMBLY for Standard Barreled Models

## Step 1 - Magazine Removal & Chamber Check

*Point gun in a safe direction.*

1. Press magazine catch and remove magazine.
2. Pull slide backwards and check that no cartridge is in the chamber.
3. Release slide allowing it to go to forward position.



## Step 2 - Recoil Spring Removal

*Point gun in a safe direction.*

1. If your pistol contains a full length guide rod, use a 5/32 allen wrench or a screwdriver to remove the front portion of guide rod. If your pistol does not contain a full length guide rod, skip to step 3.
2. Grip slide behind the front sight, resting pistol butt on top of your knee.
3. Move slide rearward, approximately 1/2 inch grasp firmly to hold in place, and depress recoil spring plug with thumb.
4. Point muzzle away from face and rotate barrel bushing clockwise.
5. Do not rotate bushing off a plug unless you have control of plug and spring.

## Step 3

Cautiously allow plug and recoil spring to move forward.



## Step 4 - Slide Stop Removal

1. Align disassembly notch on slide with slide stop.
2. Press slide stop shaft on right side of frame and remove slide stop by pulling it out of left side of frame.



## Step 5 - Slide Removal

Pull the slide forward in its guides and remove slide. Barrel, barrel bushing, recoil spring plug, recoil spring and guide will come with it.

**WARNING:** Point muzzle away from face to prevent injury in the event plug is ejected by spring.

## Step 6 - Recoil Spring Components Removal

Remove recoil spring and guide through back side.

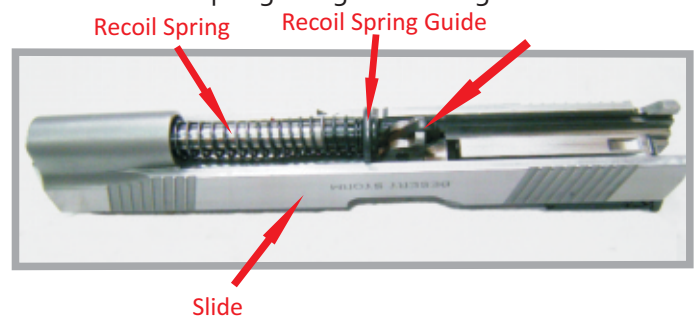

## Step 7 - Barrel Removal

1. Rotate barrel bushing to left of slide and remove it through the front.
2. Tilt barrel link forward and remove barrel from front of slide.

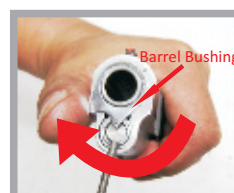

Step 7-1



Step 7-2



# DISASSEMBLY for Titan & Sigma 9 Models

## Step 1 - Magazine Removal & Chamber Check

*Point gun in a safe direction.*

1. Press magazine catch and remove magazine.
2. Pull slide backwards and check that no cartridge is in the chamber.
3. Release slide allowing it to go to forward position.



## Step 2 - Slide Stop Removal

1. Align disassembly notch on slide with slide stop.
2. Press slide stop shaft on right side of frame and remove slide stop by pulling it out of left side of frame.



## Step 3 - Slide Removal

Pull the slide forward in its guides and remove slide carefully holding the recoil spring's tension so that it will not dislodge prematurely and the group will not be thrown away. Barrel, barrel bushing, recoil spring plug, recoil spring and guide will come with it.



## Step 4 - Recoil Spring Components Removal

Pull-out the recoil group cautiously allowing the spring tension to move forward.



## Step 5 - Barrel Removal

1. Take-out reverse plug to right of slide.
2. Tilt barrel link forward and remove barrel from front of slide.

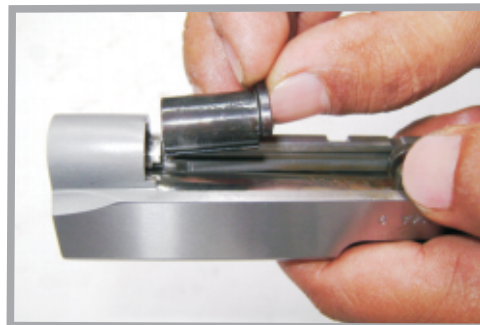

Step 5-1

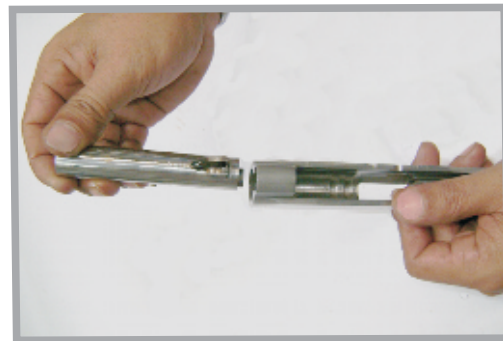

Step 5-2



**BE SAFE!** Be sure pistol is unloaded before starting disassembly! Wear eye protection as gun contains spring-loaded parts that might accidentally injure the eyes.

# ASSEMBLY

Assemble by reversing the order of disassembly.

**Note:** When replacing recoil assembly (*Step 6*), be certain the recoil spring guide and recoil spring are aligned with the barrel before inserting in slide. Be sure to flip barrel link forward before installing slide assembly. Slide stop shaft must go through hole in barrel link.



An improperly assembled firearm is dangerous and should not be fired. Always consult an expert gunsmith if you experience difficulty or have any questions concerning assembly procedure.

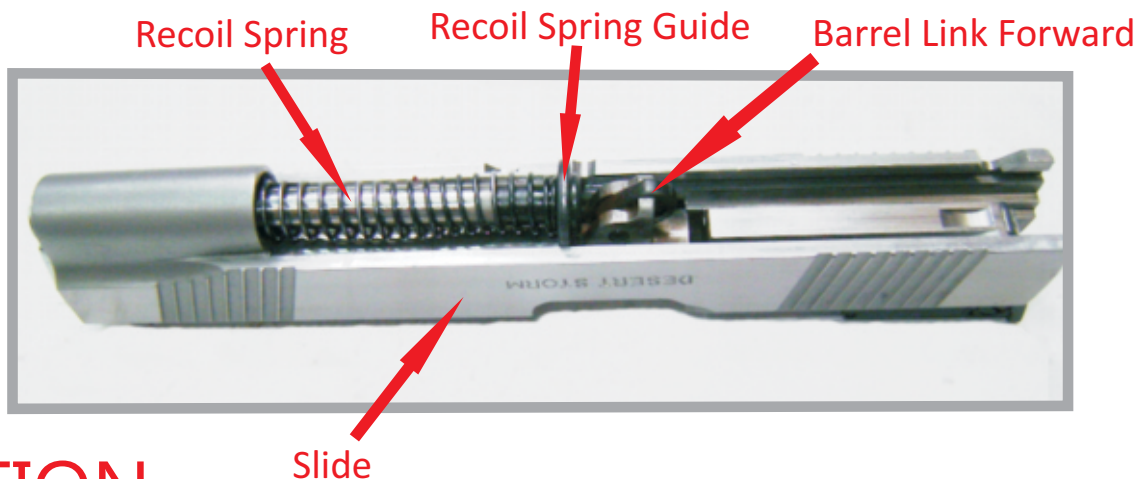

## CAUTION

Never leave pistol cocked and ready to fire as this creates an extremely dangerous situation for accidental firing that may cause property damage, injury or death.

A gun lock is provided with this firearm. Follow the instructions for its use. Proper use will prevent the gun from being fired accidentally. No mechanical device is a substitute for safe gun handling. Every household member should be trained in safe gun handling practices.

## TREAT EVERY GUN AS IF IT IS LOADED... ALL THE TIME!

- ☠ Many ammunition identifications sound similar. Make sure you use the right size ammunition in your gun.
- ☠ If the gun fails to fire when the trigger is pulled, keep it pointed at the target for at least 30 seconds before opening the action and removing the cartridge from the chamber. Sometimes slow primer ignition will cause a "hang fire" and the cartridge will go off after a short pause.
- ☠ When group firing, always appoint someone to maintain safety control. Obey his/her commands immediately.
- ☠ While the shooter is loading, firing, and unloading, spectators should be at least 10 feet behind the shooter.
- ☠ Always wear protective glasses when shooting
- ☠ Always wear hearing protection when shooting.
- ☠ Never shoot at hard flat surfaces or water as bullets will ricochet.
- ☠ Do not alter or modify your gun.
- ☠ Have your gun serviced regularly by a qualified gunsmith.
- ☠ Discharging and cleaning or handling ammunition or firearms in poorly ventilated areas may result in exposure to lead and other substances known to cause birth defects, reproductive harm, cancer and other serious physical injury. Have adequate ventilation at all times. Wash hands thoroughly after exposure.

# 1911 Pistol 45 ACP Exploded View

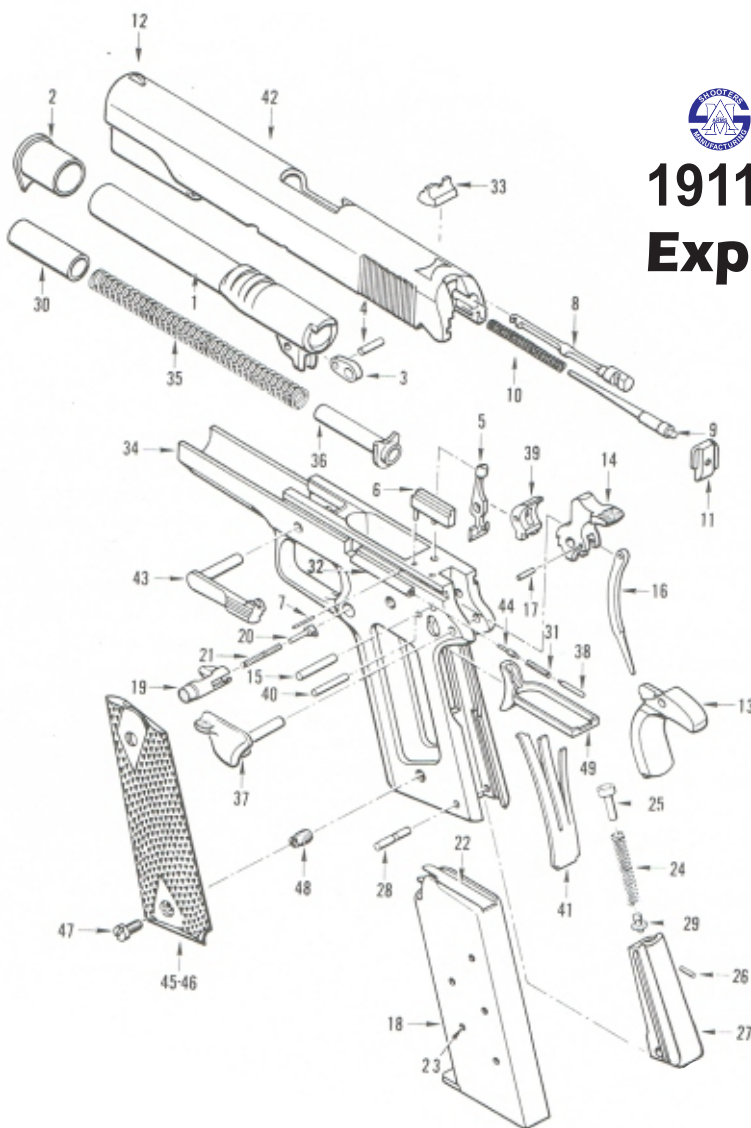

- |                         |                              |                       |
|-------------------------|------------------------------|-----------------------|
| 1. Barrel               | 21. Magazine Catch Spring    | 38. Plunger Pin Long  |
| 2. Barrel Bushing       | 22. Magazine Follower        | 39. Sear              |
| 3. Barrel Link          | 23. Magazine Spring (inside) | 40. Sear Pin          |
| 4. Barrel Link Pin      | 24. Main Spring              | 41. Sear Spring       |
| 5. Disconnecter         | 25. Retainer Cap             | 42. Slide             |
| 6. Ejector              | 26. Follower Housing Pin     | 43. Slide Stop        |
| 7. Ejector Pin          | 27. Main Spring Housing      | 44. Plunger Pin Short |
| 8. Extractor            | 28. Housing Pin              | 45. Grip              |
| 9. Firing Pin           | 29. Retainer Guide           | 46. Grip              |
| 10. Firing Pin Spring   | 30. Recoil Spring Plug       | 47. Grip Screw Male   |
| 11. Firing Pin Stop     | 31. Plunger Spring           | 48. Grip Screw Female |
| 12. Front Sight         | 32. Plunger Tube             | 49. Trigger           |
| 13. Safety Grip         | 33. Rear Sight               |                       |
| 14. Hammer              | 34. Frame                    |                       |
| 15. Hammer Pin          | 35. Recoil Spring            |                       |
| 16. Hammer Strut        | 36. Recoil Spring Guide      |                       |
| 17. Hammer Strut Pin    | 37. Safety Lock              |                       |
| 18. Magazine Assembly   |                              |                       |
| 19. Magazine Catch      |                              |                       |
| 20. Magazine Catch Lock |                              |                       |

# CARE AND CLEANING

## Basic materials needed:

- ☀ Cleaning rod of proper size with bristle bore brushes (fiber or brass) and tip to which cleaning patch can be inserted.
- ☀ Cloth patches
- ☀ Powder solvent
- ☀ Lubricating oil
- ☀ Small lint-free cloths for wiping and oiling
- ☀ Bristle brush for scrubbing dirt off breech space, extractor, magazine lips, follower, etc.

Use proper size bore brushes and patches - if they are too small they won't do the job, and they are too large they will bind inside bore.

When possible, insert cleaning rod from chamber end of bore and push rod all the way through so it emerges from muzzle.

Do not "reverse" rod direction when patch or brush is in barrel, it might bind.

Do not use patches dripping with solvent or oil. Wet patches or brushes, then squeeze out excess before using.

When use bore brushes or a larger bristle brush on breech face, breech areas, magazines, etc., work carefully to prevent damaging components.

**Note:** *If lower parts of receiver and its mechanism are especially dirty, soak in appropriate solvent, or flush clean with same solvent. Remove grip panels before soaking or flushing, and make certain that all foreign matter is removed after cleaning. Lightly oil after cleaning.*

*Only a very small amount of oil is needed to adequately lubricate moving parts and prevent rust. Stainless steel pistols require slightly more lubrication than parkerized or blued pistols. Accumulation of oil tends to attract dust and dirt which interferes with the safe and reliable functioning of pistol. Do not apply excess lubricating oil.*



Wear eye protection when using solvent. Thoroughly wash your hands to remove powder and solvents after cleaning your gun.

# CLEANING PISTOL

1. Point gun in safe direction.
2. Remove magazine and empty chamber.
3. Separate cartridges from pistol before cleaning operation.
4. Open slide and visually check that chamber and magazine well are free of cartridges.
5. Disassemble pistol as describe in the proper DISASSEMBLY Section.
6. Using cleaning rod, run solvent-wetted patch through barrel several times.
7. Attach solvent-wetted bristle brush to rod and run back and forth full length of bore as needed until clean of grease and dirt.
8. Clean barrel with dry patches and examine it. If necessary, repeat barrel scrubbing. Bore fouling can contribute to reduce accuracy, and grease accumulation in the chamber can interfere with proper feeding of cartridges from magazine.
9. Using powder solvent on a clean patch, remove powder residue from all components of mechanism. If grease or dirt cannot be removed by wiping with patch, use a solvent-wetted bristle brush.
10. Next, wipe scrubbed areas with solvent-wetted patch.
11. After cleaning, run dry patch through barrel, then follow with lightly-oiled patch.
12. Wipe all surfaces clean with cloth, then wipe all surfaces with lightly-oiled patch (or cloth).
13. Reassemble pistol. Remember, an improperly assembled firearm is dangerous and should not be fired. Always consult an experienced gunsmith if you experience any difficulty or have any questions concerning assembly procedure.
17. If pistol is to be stored for an extended period, final oil wiping can be heavier so there will be less tendency for it to evaporate. Stainless steel pistols must be lubricated.



# PERIODIC CLEANING: EXTRACTOR

**Note:** Once the slide is removed, the firing pin removal can be done.

## Step 1 - Firing Pin Removal

1. If necessary, remove firing pin by pressing it with pin punch while simultaneously pushing firing pin tail past the firing pin stop, then pull firing pin stop downward from slide.
2. Remove firing pin and its spring.

## Step 2 - Extractor Removal

1. Using pin punch, extractor by groove where firing pin stop runs.



**Caution:** Point the back end of the slide, where the firing pin exits, away from face to prevent injury in the event the firing pin is ejected by the spring

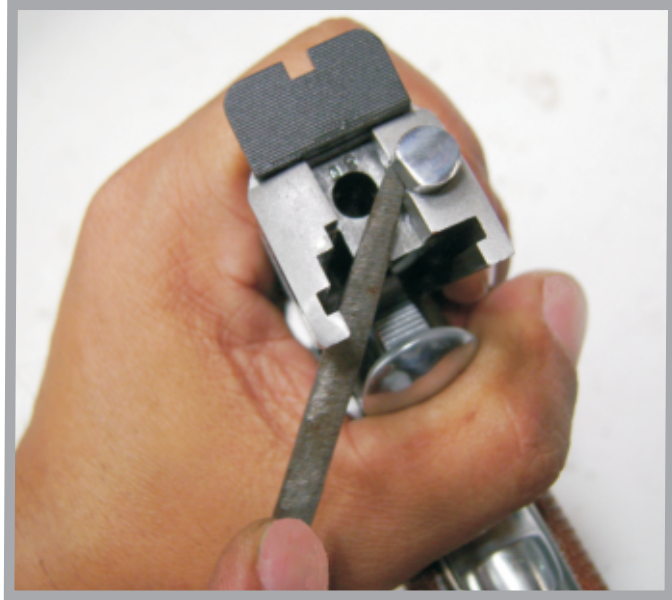

## LIMITED LIABILITY

SHOOTERS ARMS MANUFACTURING, INC. WILL NOT BE RESPONSIBLE FOR THE RESULTS OF CARELESS HANDLING, UNAUTHORIZED REPAIRS AND ADJUSTMENTS, CORROSION, NEGLIGENCE, UNREASONABLE OR UNSAFE USE.

SHOOTERS ARMS MANUFACTURING, INC. ASSUMES NO RESPONSIBILITY FOR DAMAGE AND/OR INJURY CAUSED IN WHOLE OR IN PART BY HANDLOADED, RELOADED OR DEFECTIVE AMMUNITION. UNDER NO CIRCUMSTANCES SHALL SHOOTERS ARMS MANUFACTURING, INC. BE RESPONSIBLE FOR INCIDENTAL OR CONSEQUENTIAL DAMAGES WITH RESPECT TO ECONOMIC LOSS OR INJURY TO PROPERTY ARISING OUT OF USE OF HANDLOADED OR REMANUFACTURED AMMUNITION, NEGLIGENCE, UNSAFE HANDLING, OR UNAUTHORIZED MODIFICATIONS TO THE FIREARM.

\*TECHNICAL SPECIFICATIONS MAY BE ALTERED WITHOUT NOTICE.



**Model 1911 Pistols are classified firearms and dangerous weapons. Injury or death to you or others may result from unsafe or improper use.**



Always wear eye and ear protection when using any firearm.



**SHOOTERS**  
ARMS MANUFACTURING INCORPORATED

Ting Guan Cmpd., Sacris Road Ext., Tipolo, Mandaue City, Philippines

Tel.No. (+6332) 346-2304 Fax No. (+6332) 344-8515

Email: [shootersarms\\_cebu@yahoo.com](mailto:shootersarms_cebu@yahoo.com)

website: [www.shootersarms.com.ph](http://www.shootersarms.com.ph)  
[romeldiv@yahoo.com](mailto:romeldiv@yahoo.com)